



PROJECT INFORMATION

SITE ADDRESS: 15019 and 15045 SALT LAKE AVE.
LA PUENTE, CA 91746

APN: 8208-016-002 and 017

SITE AREA: 5.69 acres (Per Assessors Information)

ZONING: M-1-BE

APPLICANT: Athens Services, Inc.
14048 Valley Blvd
Industry, CA 91746
Attn: David Oeffling
DOeffling@athensservices.com
(626) 594-4399

PROJECT

INSTALL A CNG FUELING SYSTEM CONSISTING OF (I) FAST FILL DISPENSER POST AND UP TO 130 TIME-FILL DISPENSER POSTS WHICH COULD INCLUDE: SINGLE-HOSE POSTS, DUAL HOSE POSTS AND QUAD-HOSE POSTS. DISPENSER POSTS AND GAS AND ELECTRICAL LINES WILL BE MOUNTED ON CONCRETE K-RAILS PLACED THROUGHOUT THE PARKING AREA.

THE FACILITY WILL INCLUDE AN ANCILLARY OPEN CNG MECHANICAL EQUIPMENT AREA OF APPROXIMATELY 3,800 SF THAT COULD INCLUDE UP TO 4 COMPRESSORS, CNG STORAGE VESSELS, A GAS DRYER AND A VALVE PANEL MOUNTED OUTSIDE ON CONCRETE PADS AND SURROUNDED BY A 8-FOOT TALL CMU WALL. A 230 SF PRE-FABRICATED CONTAINER MAY ALSO BE USED TO HOUSE OTHER EQUIPMENT INCLUDING AN AIR COMPRESSOR, AIR DRYER, HVAC EQUIPMENT, MOTOR CONTROL CENTER AND PANELS, A TRANSFORMER AND ELECTRICAL BREAKER PANEL.

A GAS METER SET ASSEMBLY WILL BE INSTALLED TO REGULATE AND MEASURE THE AMOUNT GAS BEING SUPPLIED BY SOUTHERN CALIFORNIA GAS CO.

ALL CONCRETE K-RAILS WILL BE SECURED TO THE GROUND WITH (4) #8 REBAR.

General Notes

No.	Revision/Issue	Date

Firm Name and Address
L. Miner and Associates

Project Name and Address
Athens Services
ATHENS SERVICES, INC.
14048 Valley Blvd.
Industry, CA 91746

Project: Salt Lake Yard CNG Project
Date: January 2, 2024
Scale: 1" = 50'

Sheet: S-1B

SITE NOTES

- EXISTING 2-STORY OFFICE BUILDING - 6,000 SF 1ST FLOOR AND 7,500 SF 2ND FLOOR.
- EXISTING 1-STORY 4-BAY TRUCK MAINTENANCE BUILDING - 5,200 SF
- EXISTING 1-STORY 4-BAY TRUCK MAINTENANCE BUILDING 2,356 SF
- EXISTING OPEN SIDED METAL CANOPY - 6,900 SF
- EXISTING ELECTRICAL ENCLOSURE
- NEW K-RAILS WITH TIME FILL CNG FUELING POSTS - 160 TOTAL (SEE FILL POST DETAILS SHEET S-2)
- NEW FAST FILL CNG FUELING POST - 1 TOTAL
- NEW K-RAILS USED TO PROTECT CNG FACILITY EQUIPMENT
- NEW CNG EQUIPMENT AREA (SEE EQUIPMENT PLAN DETAIL SHEET S-2)
- NEW 8-FOOT TALL CMU BLOCK WALL SURROUNDING EQUIPMENT AREA WITH ACCESS DOORS.
- NEW METER SET ASSEMBLY

PARKING REQUIRED PER PLOT PLAN RPP 200900053

AUTO PARKING - 60 SPACES
HANDICAPPED PARKING - 2 SPACES
TRUCK PARKING - 41 SPACES

CURRENT PARKING PROVIDED

AUTO PARKING - 125 SPACES
HANDICAPPED PARKING - 3 SPACES
TRUCK PARKING - 160 SPACES

TOTAL PARKING: 288 SPACES

Note: (T) - Truck Parking Space

CONTEXTUAL SITE PLAN

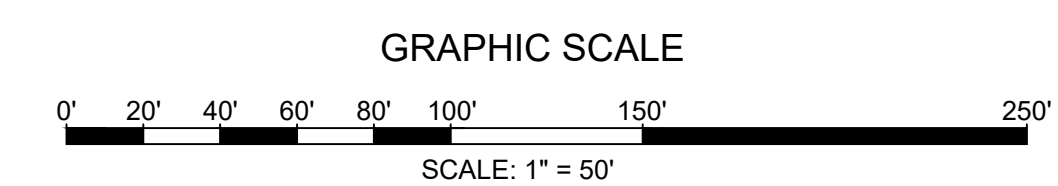

SITE PLAN

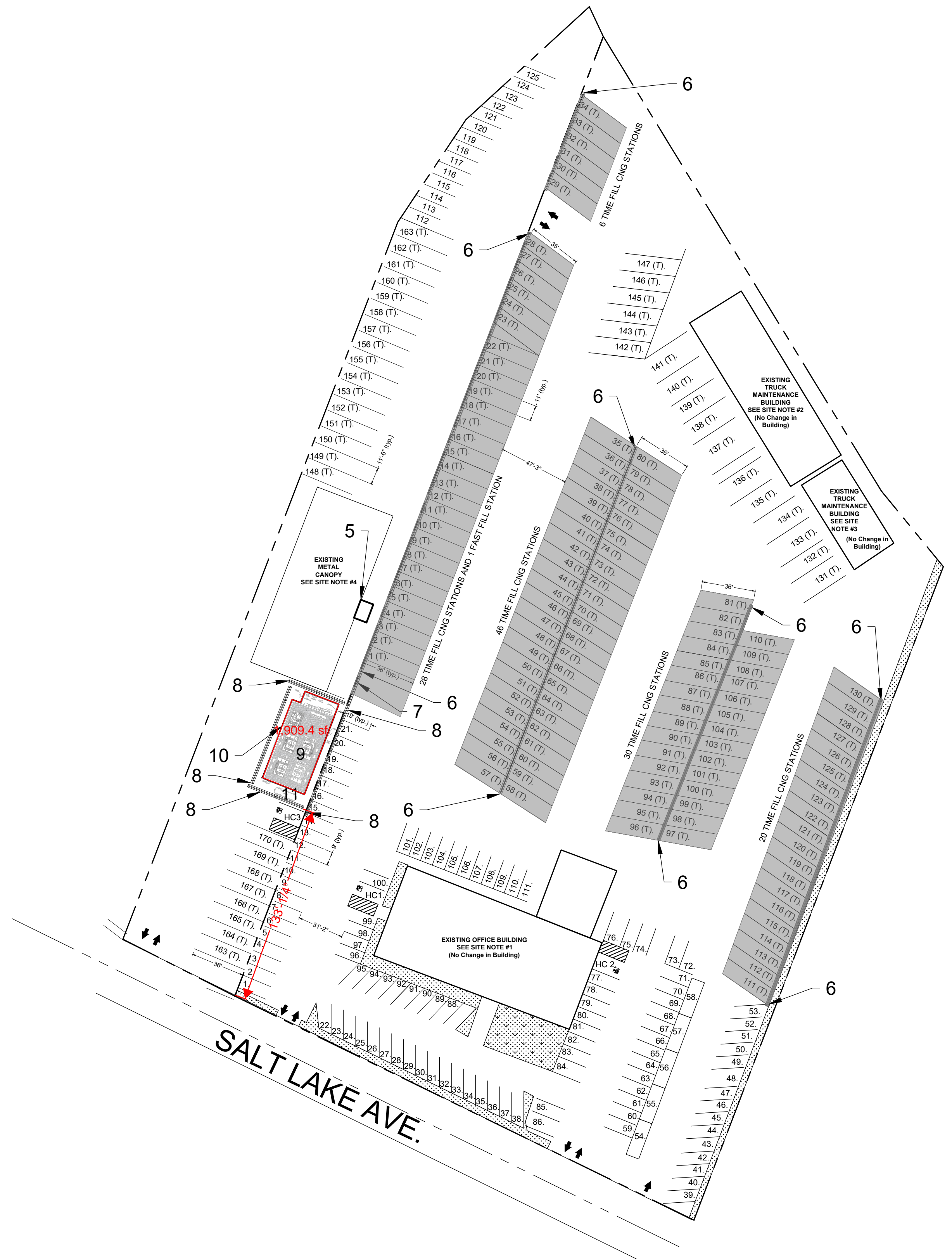

PROJECT INFORMATION

SITE ADDRESS: 15019 and 15045 SALT LAKE AVE.
LA PUENTE, CA 91746

APN: 8208-016-002 and 017

SITE AREA: 5.69 acres (Per Assessors Information)

ZONING: M-1-BE

APPLICANT: Athens Services, Inc.
14048 Valley Blvd
Industry, CA 91746
Attn: David Oeffling
DOeffling@athensservices.com
(626) 594-4399

PROJECT

INSTALL A CNG FUELING SYSTEM CONSISTING OF (1) FAST FILL DISPENSER POST AND 130 TIME-FILL DISPENSER POSTS WHICH COULD INCLUDE: SINGLE-HOSE POSTS, DUAL HOSE POSTS AND QUAD-HOSE POSTS. DISPENSER POSTS AND GAS AND ELECTRICAL LINES WILL BE MOUNTED ON CONCRETE K-RAILS PLACED THROUGHOUT THE PARKING AREA.

THE FACILITY WILL INCLUDE AN ANCILLARY OPEN CNG MECHANICAL EQUIPMENT AREA OF APPROXIMATELY 3,800 SF THAT COULD INCLUDE UP TO 4 COMPRESSORS, CNG STORAGE VESSELS, A GAS DRYER AND A VALVE PANEL MOUNTED OUTSIDE ON CONCRETE PADS AND SURROUNDED BY A 8-FOOT TALL CMU WALL. A 230 SF PRE-FABRICATED CONTAINER MAY ALSO BE USED TO HOUSE OTHER EQUIPMENT INCLUDING AN AIR COMPRESSOR, AIR DRYER, HVAC EQUIPMENT, MOTOR CONTROL CENTER AND PANELS, A TRANSFORMER AND ELECTRICAL BREAKER PANEL.

A GAS METER SET ASSEMBLY WILL BE INSTALLED TO REGULATE AND MEASURE THE AMOUNT GAS BEING SUPPLIED BY SOUTHERN CALIFORNIA GAS CO.

ALL CONCRETE K-RAILS WILL BE SECURED TO THE GROUND WITH (4) #8 REBAR.



SITE NOTES

- EXISTING 2-STORY OFFICE BUILDING - 6,000 SF 1ST FLOOR AND 7,500 SF 2ND FLOOR.
- EXISTING 1-STORY 4-BAY TRUCK MAINTENANCE BUILDING - 5,200 SF.
- EXISTING 1-STORY 4-BAY TRUCK MAINTENANCE BUILDING 2,356 SF
- EXISTING OPEN SIDED METAL CANOPY - 6,900 SF
- EXISTING ELECTRICAL ENCLOSURE
- NEW K-RAILS WITH TIME FILL CNG FUELING POSTS -160 TOTAL (SEE FILL POST DETAILS SHEET S-2)
- NEW FAST FILL CNG FUELING POST - 1 TOTAL
- NEW K-RAILS USED TO PROTECT CNG FACILITY EQUIPMENT
- NEW CNG EQUIPMENT AREA (SEE EQUIPMENT PLAN DETAIL SHEET S-2)
- NEW 8-FOOT TALL CMU BLOCK WALL SURROUNDING EQUIPMENT AREA WITH ACCESS DOORS.
- NEW METER SET ASSEMBLY

LEGEND

■ - SHADED AREAS DENOTE COLLECTION TRUCK CNG FUELING LOCATIONS.

PARKING REQUIRED PER PLOT PLAN RPP 200900053

AUTO PARKING - 60 SPACES
HANDICAPPED PARKING - 2 SPACES
TRUCK PARKING - 41 SPACES

CURRENT PARKING PROVIDED

AUTO PARKING - 125 SPACES
HANDICAPPED PARKING - 3 SPACES
TRUCK PARKING - 160 SPACES

TOTAL PARKING: 288 SPACES

Note: (T) - Truck Parking Space

General Notes		
No.	Revision/Issue	Date
Firm Name and Address		
L. Miner and Associates		
Project Name and Address		
ATHENS SERVICES, INC. SALT LAKE YARD 14048 Valley Blvd. Industry, CA 91746		
Project	Sheet	
Salt Lake Yard CNG Project	S-1A	
Date	Scale	
January 2, 2024	1" = 50'	

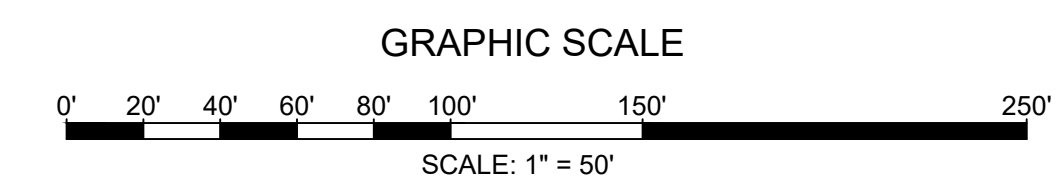

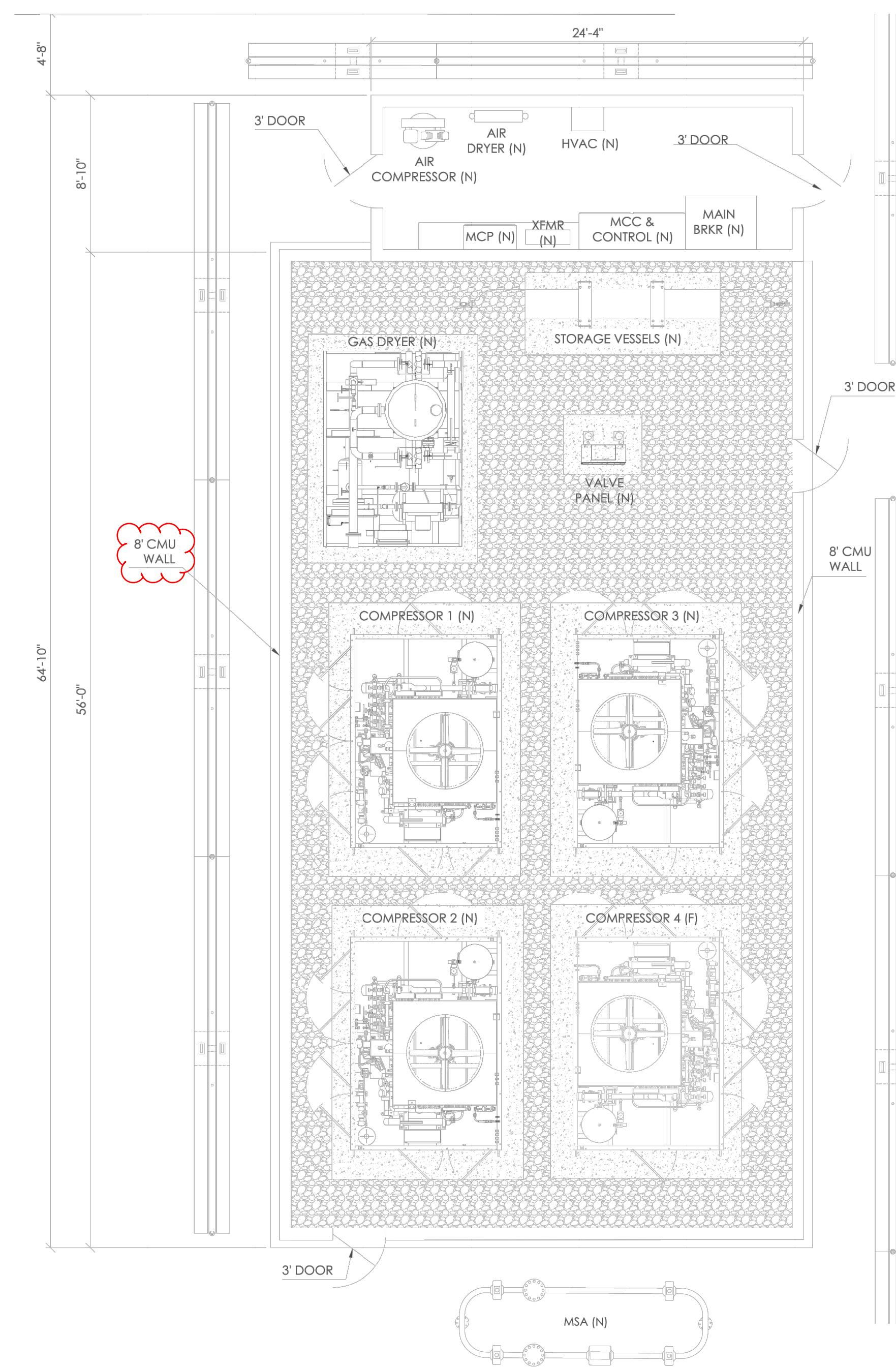

EQUIPMENT PLAN DETAIL

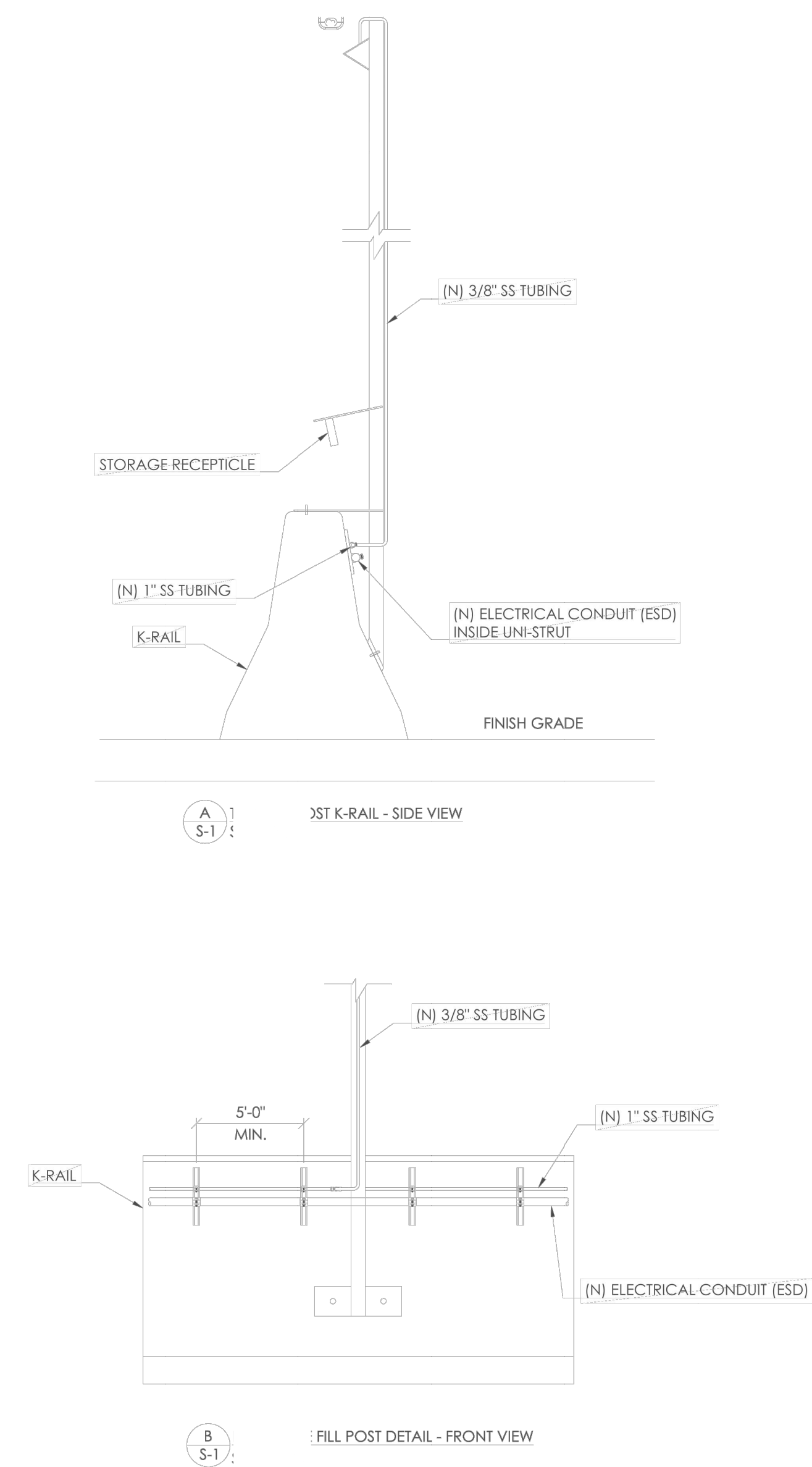

FILL POST DETAILS

General Notes

No.	Revision/Issue	Date

Firm Name and Address
L. Miner and Associates

Project Name and Address
ATHENS SERVICES, INC.

 14048 Valley Blvd.
 Industry, CA 91746

Project Salt Lake Yard CNG Project	Sheet S-2
Date January 2, 2024	
Scale No Scale	