

NOTE:

HABITAT ZONES SHOWN ON THIS EXHIBIT ARE TAKEN FROM COUNTY OF LA PLANNING SANTA MONICA MOUNTAINS GIS MAPPING WEB SITE

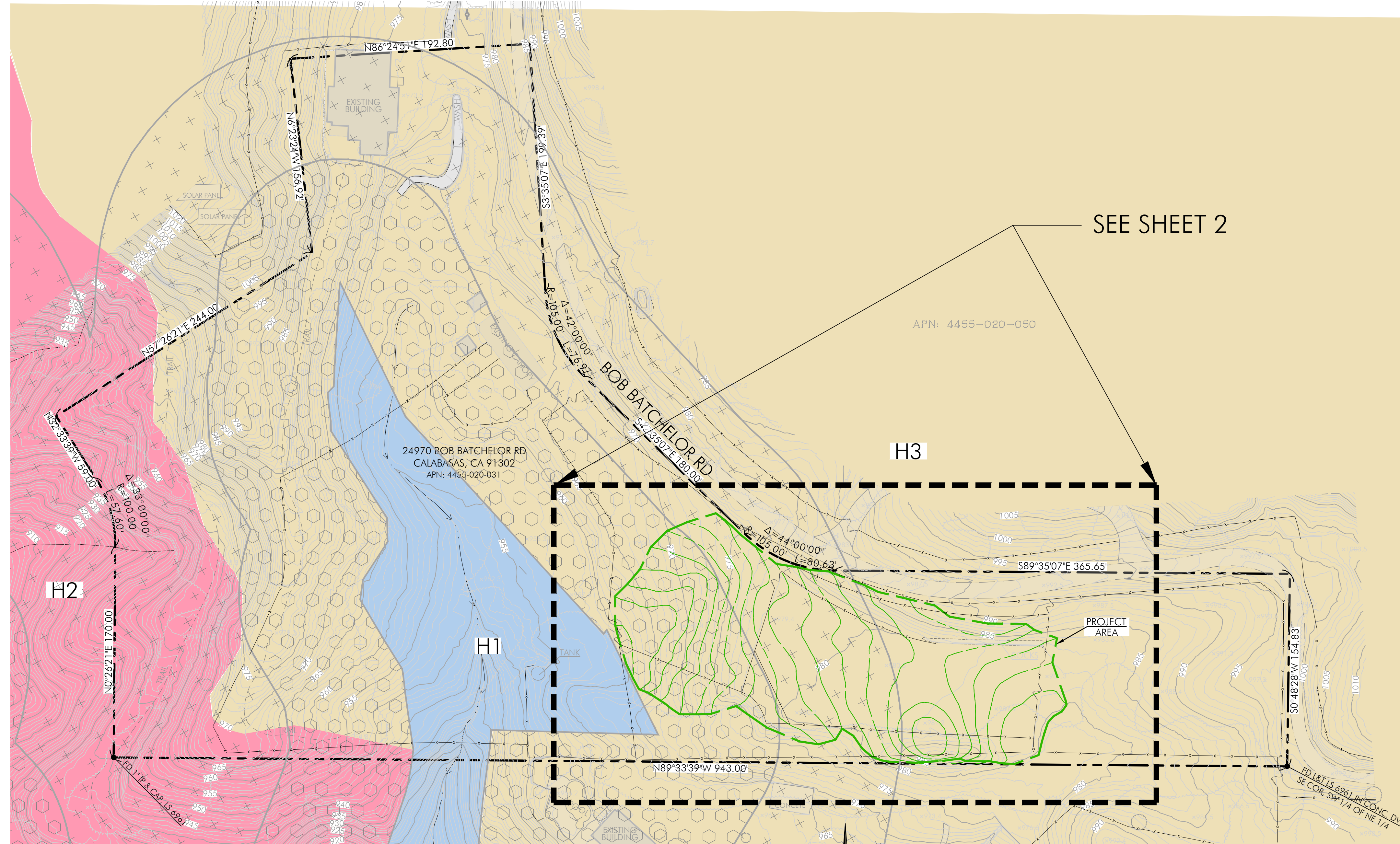

SEE SHEET 2

APN: 4455-020-050

24970 BOB BATCHELOR RD
CALABASAS, CA 91302
APN: 4455-020-031

OVERALL BOUNDARY SITE
SCALE: 1"=50'

- LEGEND:**
- H1 HABITAT ZONE
 - H1 HABITAT 100' BUFFER ZONE
 - H1 HABITAT QUIET ZONE
 - H2 HABITAT ZONE
 - H3 HABITAT ZONE

- LEGEND:**
- P/L PROPERTY LINE
 - SPOT ELEVATION
 - FLOW LINE
 - CUT FILL LINE
 - EXISTING CONTOUR
 - RESTORED CONTOUR (GRADE) OF THE ORIGINAL CONDITION
 - LIMIT OF UNPERMITTED WORK
 - PROPERTY BOUNDARY

BENCHMARK:
BM NUMBER: DY11654
QUAD YEAR: 2020
ELEVATION = 1043.240 FT (317.980 M)
DESCRIPTION: LACO BM TAG IN S CB OF CONC DRAIN 23' Q/O C/L MULHOLLAND HWY & 16' S/O XL PROD STUNT RD (FROM THE E)

PREPARED BY: **PACIFIC COAST CIVIL, INC.**
351 ROLLING OAKS DR., SUITE 202
THOUSAND OAKS, CA 91361
PH: (818) 865-4168
WWW.PACIFICCOASTCIVIL.COM

OWNER/DEVELOPER:
SARAH & STEPHEN PHILLIPS
24970 BOB BATCHELOR RD
CALABASAS, CA 91302
(310) 728-5224 (Sarah)

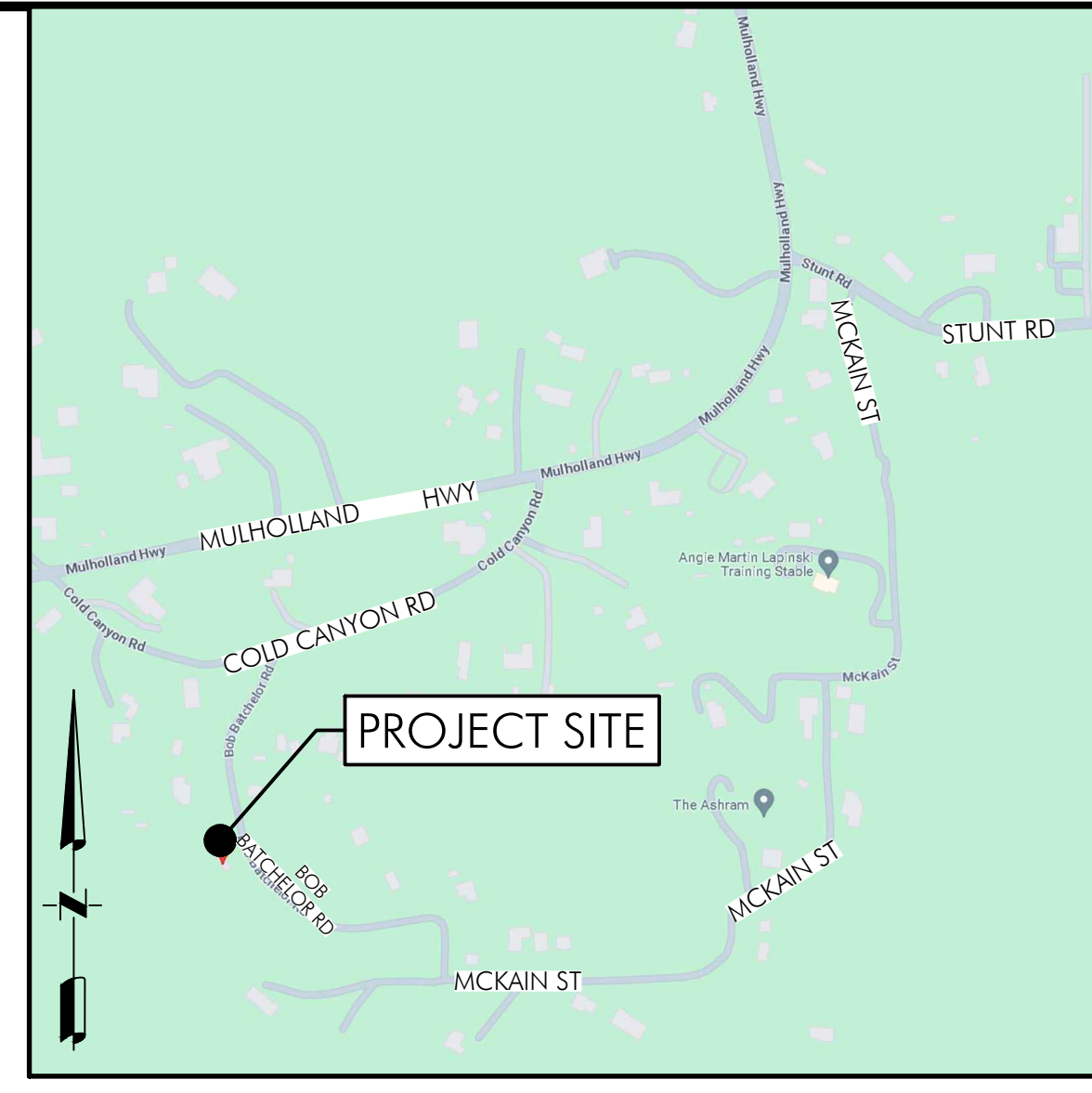
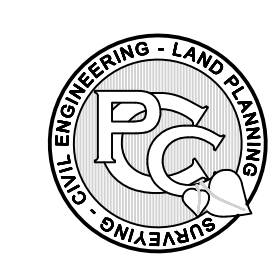

VICINITY MAP
N.T.S.

PROJECT STATISTICS:

PARCEL SIZE: 6.6 ACRES (287496 SQ.FT.)

ZONING: RC-40

LAND USE: RL40 - RURAL LANDS (1 DU / 40 AC)

EARTHWORK QUANTITIES
QUANTITIES ARE FOR PLAN CHECK PURPOSES AND ARE NOT TO BE USED FOR BID PURPOSES

RAW CUT:	FILL:	EXPORT:
2,301 C.Y.	2,301 C.Y.	BALANCE ON SITE

HORSE CORRAL SITE PLAN BOB BATCHELOR RD



24970 BOB BATCHELOR RD
CALABASAS, CA 91302
APN: 4455-020-031

LEGAL DESCRIPTION
SEC/TWN/RNG/MER: SEC 09 T2N 01S R17W
*LAND DESC IN DOC 0004008,760902 *POR OF SW 1/4 OF NE 1/4 OF SEC 9 T1S R17W

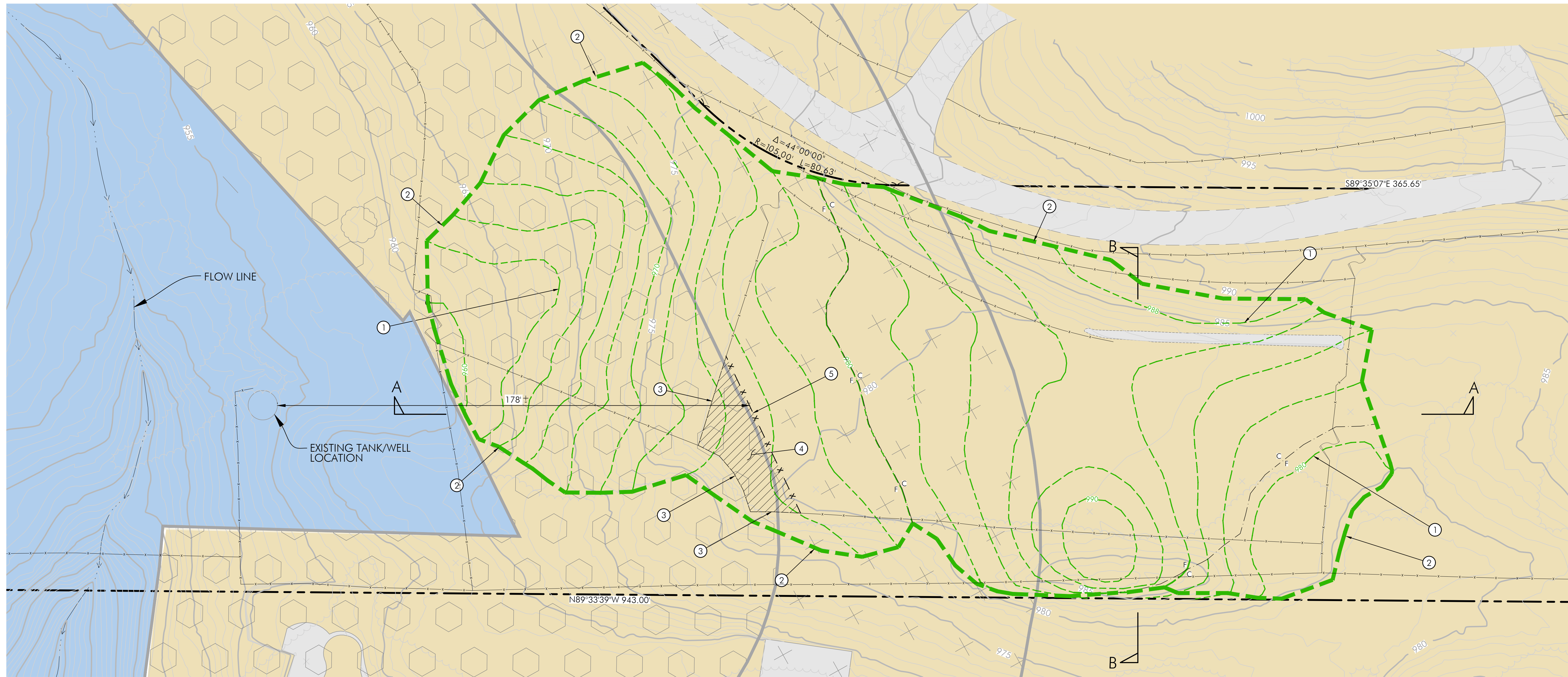
January 12, 2026

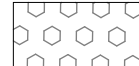
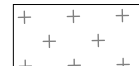

HABITAT ZONE LEGEND:

-  H1 HABITAT ZONE
-  H1 HABITAT 100' BUFFER ZONE
-  H1 HABITAT QUIET ZONE
-  H3 HABITAT ZONE

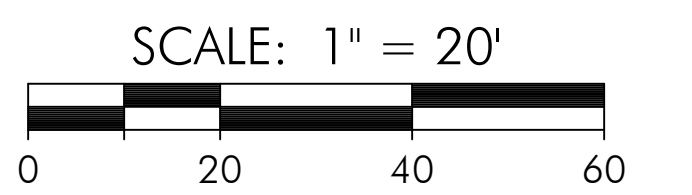
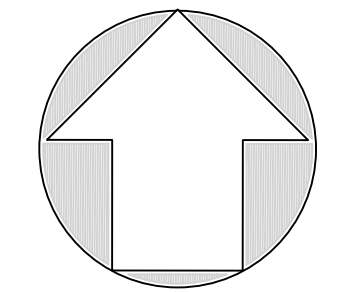

EARTHWORK QUANTITIES

QUANTITIES ARE FOR PLAN CHECK PURPOSES AND ARE NOT TO BE USED FOR BID PURPOSES

RAW CUT:	FILL:	EXPORT:
2,301 C.Y.	2,301 C.Y.	BALANCE ON SITE

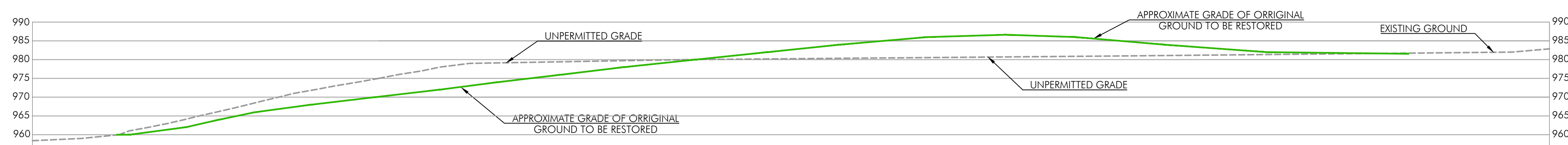

SECTION A-A
SCALE: 1"=20'

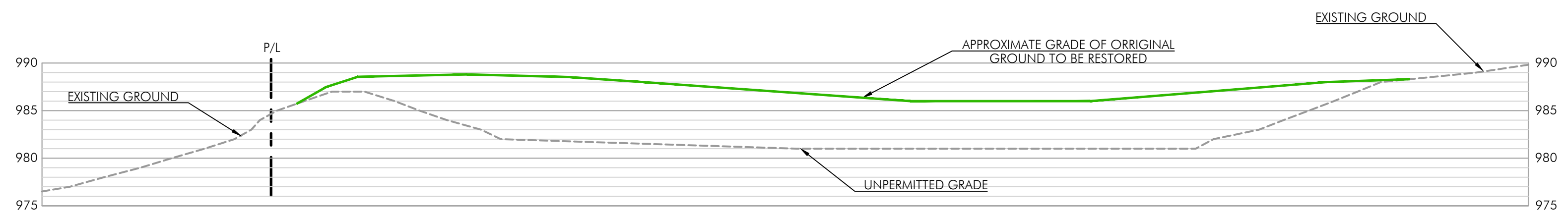













SECTION B-B
SCALE: 1"=10'

CONSTRUCTION NOTES:

- ① APPROXIMATE GRADE/CONTOURS OF ORIGINAL GROUND TO BE RESTORED
- ② LIMIT OF UNPERMITTED WORK
- ③ RELOCATE /REMOVE PORTION OF EXISTING FENCE OUTSIDE OF H1 HABITAT 100' BUFFER ZONE
- ④ REMOVE ANY ADDED SOIL, PORTION TO BE RESTORED TO NATURAL VEGETATION, AND COVER THE AFFECTED AREA WITH TRIMMINGS OF NEARBY BRUSH CLEARANCE.
- ⑤ NEW LOCATION OF FENCE OUTSIDE OF H1 HABITAT 100' BUFFER ZONE

LEGEND:

-  P/L PROPERTY LINE
-  SPOT ELEVATION
-  FLOW LINE
-  CUT FILL LINE
-  CUT FILL LINE
-  EXISTING CONTOUR
-  RESTORED CONTOUR (GRADE) OF THE ORIGINAL CONDITION
-  LIMIT OF UNPERMITTED WORK
-  PROPERTY BOUNDARY
-  EXISTING FENCE
-  EXISTING FENCE TO BE REMOVED
-  NEW FENCE LOCATION

HORSE CORRAL SITE PLAN BOB BATCHELOR RD

24970 BOB BATCHELOR RD
CALABASAS, CA 91302
APN: 4455-020-031

OWNER/DEVELOPER:

SARAH & STEPHEN PHILLIPS
24970 BOB BATCHELOR RD
CALABASAS, CA 91302
(310) 728-5224 (Sarah)

PREPARED BY:

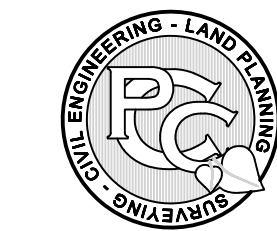

PACIFIC COAST CIVIL, INC.
351 ROLLING OAKS DR., SUITE 202
THOUSAND OAKS, CA 91361
PH: (818) 865-4168
WWW.PACIFICCOASTCIVIL.COM